

ARC S LED

Emergency Lighting

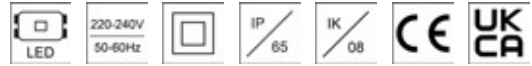

LOA



TRACK

DESCRIPTION: Surface mounted LED emergency escape luminaire
Light distribution type: direct
Optical system: lenses
Housing: polycarbonate
Colour: white; light grey; black
Battery charging time: 24 hours (12 hours optional: AUT)
Battery: NiCd (LiFePO4 optional: AUT), deep discharge protection

GENERAL DATA: Mains voltage: 220-240V, 50-60Hz
 LED lifetime, h: 70000/L80B10
 SDCM: 3
 Protection class IEC: II
 Ingress protection code: IP65
 Mechanical impact resistance: IK08
 Operating temperature range, °C: ta 0...+40 (CEBLED, CLV2 ta -25...+50)

INSTALLATION: On the ceiling or suspended (suspension bracket, wire to be ordered on request). Push-in terminal, 3x2x2.5mm²

ENVIRONMENT: Indoor

APPLICATION: Escape route lighting

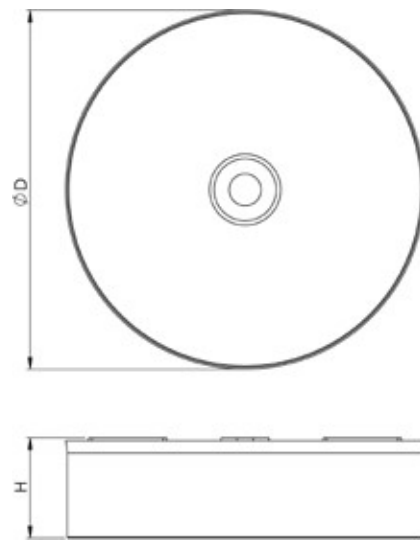

PRODUCT	DIAMETER, mm	HEIGHT, mm	ILLUMINATION MODE	EMERGENCY OPERATING TIME, H	LUMINAIRE OUTPUT*, lm	POWER IN EMERGENCY MODE, W*	CRI	CCT*, K	WEIGHT, kg
ARC S 1HLED C379 LER IP65	202	58	NM	1	180	1	80+	6000	1,4
ARC S 3HLED C380 LER IP65	202	58	NM	3	180	1	80+	6000	1,4
ARC S 1PLED C381 LER IP65	202	58	M/NM	1	180	1	80+	6000	1,4
ARC S 3PLED C382 LER IP65	202	58	M/NM	3	180	1	80+	6000	1,4
ARC S CEBLED C383 LER IP65	202	58	CEB	x	185	1	80+	6000	1,4
ARC S 1PLED C386 LER IP65	202	58	M/NM	1	390	3	80+	6000	1,4
ARC S 3PLED C387 LER IP65	202	58	M/NM	3	390	3	80+	6000	1,5
ARC S CEBLED C388 LER IP65	202	58	CEB	x	460	3	80+	6000	1,4
ARC S 1PLED C391 LER IP65	202	58	M/NM	1	790	6	80+	6000	1,5
ARC S 3PLED C392 LER IP65	202	58	M/NM	3	790	6	80+	6000	1,8
ARC S CEBLED C393 LER IP65	202	58	CEB	x	790	6	80+	6000	1,5
ARC S CLV2 U70 LER IP65	202	58	CLV2	x	790	6	80+	6000	1,5

*M - maintained (with an option of connecting as non-maintained), NM - non-maintained, CEB maintained, system power and output indicates data in emergency mode, tolerance range for optical and electrical data: ±10%, values apply to an ambient temperature of 25°C

AVAILABLE ACCESSORIES:



Product: Suspension MTG KIT SUSI
Description: Suspension wire set "I" type, 1.5m adjustable, 1pcs
 *note - 1pcs MTG SUSI KIT for luminaire
 *note - SUS option is required

OPTIONS AVAILABLE ON REQUEST:

	EMERGENCY		CONNECTION	OTHER	PROTECTION
DALI ¹	LOU	CEB	TRACK ⁵	SUS	tmin-25
LER	LOS	CLV2 ³			
LOA	TEST	EMS ⁴			
LEW	AUT ²				

1 DALI option is applicable for models: C381, C382, C386, C387, C391, C392

2 AUT option is applicable for models: C381, C382, C386, C387, C391, C392

3 Only for U70 model

4 EMS option is applicable for models: C381, C382, C386, C387, C391, C392

5 Only for non-maintained operation

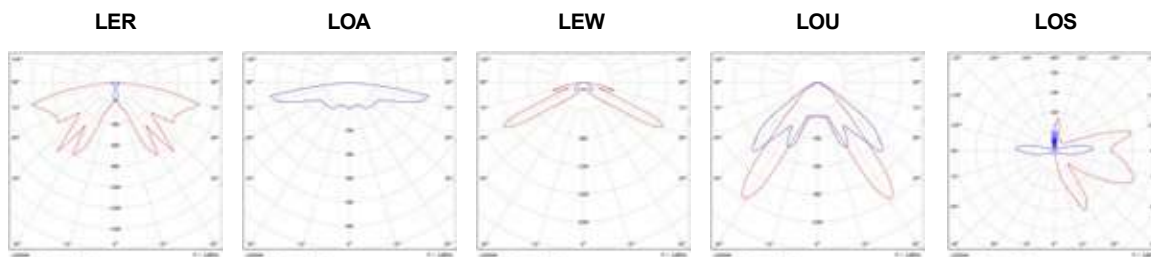

PHOTOMETRY OF LER / LOA

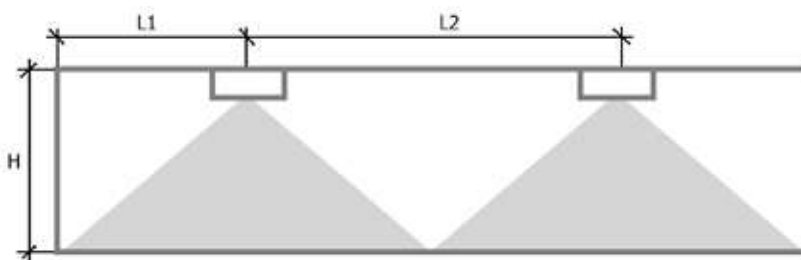

L1 - distance from the wall to the first fixture

L2 - distance between fixtures

H - height of the ceiling

LER optic for corridor route illumination:

LER - 1W/185lm min. 1lx			LER - 3W/460lm min. 1lx			LER - 6W/790lm min. 0.5lx		
H, m	L1, m	L2, m	H, m	L1, m	L2, m	H, m	L1, m	L2, m
2,5	6,0	15,0	2,5	8,0	20,0	2,5	10,0	24,5
3,0	6,5	16,0	3,0	8,5	21,5	3,0	11,0	27,0
3,5	6,5	17,0	3,5	9,0	23,0	3,5	11,5	28,5
4,0	7,0	18,0	4,0	9,5	24,5	4,0	12,0	31,5
4,5	7,5	18,5	4,5	10,0	25,5	4,5	12,5	32,5
5,0	7,0	18,0	5,0	10,0	26,5	5,0	13,0	32,5
6,0	7,0	17,0	6,0	10,5	28,0	6,0	14,0	35,5
			7,0	11,0	29,5	7,0	15,0	38,0
			8,0	11,5	30,0	8,0	15,5	40,0
			9,0	11,5	31,1	9,0	16,0	41,5
						10,0	16,5	42,0

LOA optic for open area illumination:

LOA - 1W/190lm min. 0.5lx			LOA - 3W/460lm min. 0.5lx			LOA - 6W/780lm min. 0.5lx		
H, m	L1, m	L2, m	H, m	L1, m	L2, m	H, m	L1, m	L2, m
2,5	2,5	13,5	2,5	6,0	17,0	2,5	6,5	20,0
3,0	2,5	14,0	3,0	7,0	18,0	3,0	6,5	22,5
3,5	2,5	14,5	3,5	7,5	19,5	3,5	7,0	24,0
4,0	2,0	14,5	4,0	7,5	21,0	4,0	7,5	26,5
4,5	2,0	15,0	4,5	7,0	22,5	4,5	7,5	27,5
5,0	2,0	15,0	5,0	5,5	24,0	5,0	7,0	28,5
6,0	1,5	14,5	6,0	3,0	25,0	6,0	5,5	30,5
7,0	1,0	14,0	7,0	3,0	25,5	7,0	4,5	31,0
			8,0	2,5	25,0	8,0	4,0	31,0
			9,0	2,5	24,0	9,0	4,0	31,0
			10,0	2,0	24,0	10,0	3,5	31,0